

## Bluetooth Magnet Door Sensor



**Model: BD01**

### 1. Features & Specifications:

- Wireless Communications: Bluetooth Low Energy (BLE) 5.0
- Bluetooth Transmission Range: Maximum 100meters
- Signal Output Protocol: BLE iBeacon or Eddystone broadcasting
- Battery: Replaceable CR2 1000mAh
- Battery Working Life: 5 Years Every 1000ms (1 second)
- Operating Temperature: -30°C ~ +80°C (-22°F ~ 176°F)
- Waterproof: IP69K
- Support FOTA (firmware upgrade over the air)
- Dimensions: 90mm\*30mm\*38mm
- Weight: BLE sensor--52g (Battery Include), Magnet---50g
- Materia: BLE sensor--ABS, Magnet--Alloy

### 2. Application:

Door Open/Close for asset management

### 3. Exw price

<50pcs	50~500pcs

4. BLE iBeacon Broadcasting Protocol

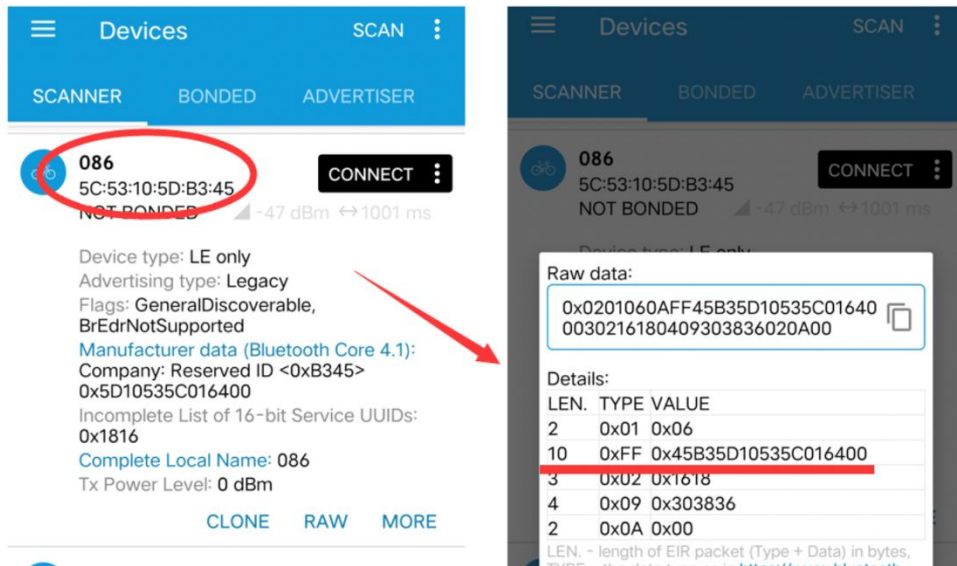

Example: 0x45B35D10535C016400

0xFF data	Data Length	Data Definition
0x45B35D10535C	6Bytes	Mac Address
0x01	1Byte	01: Door Open 00: Door Close
0x64	1Byte	Battery Balance in Percentage, 0x64 equals to 100% in decimal

5. How to quick configure?

1) Bluetooth Advertising Interval: 300~2500ms

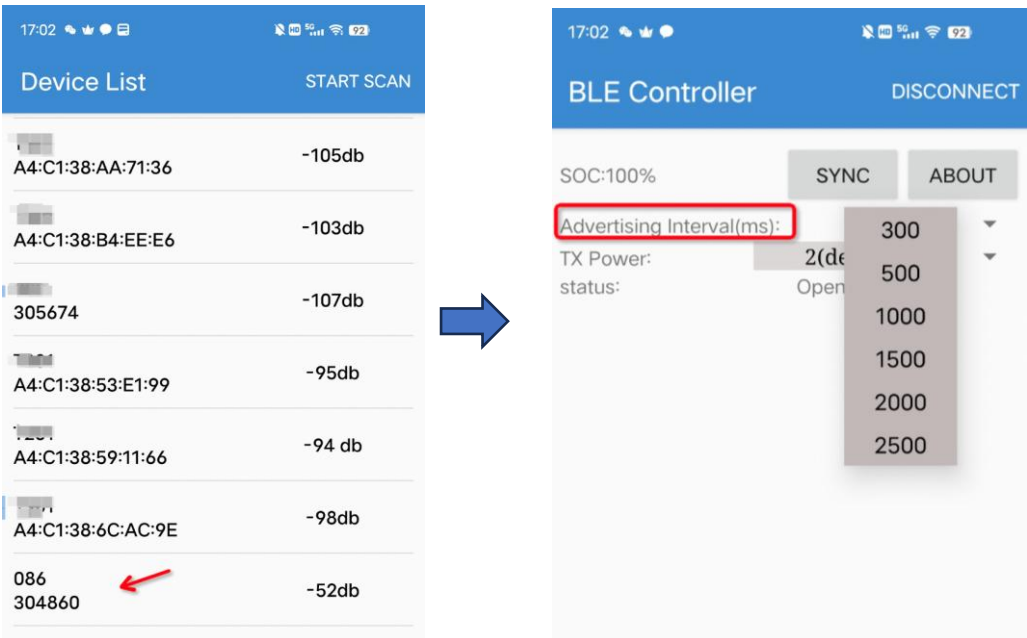

2) Broadcasting TX power: 0~6 , maximum 6 is around 100meters

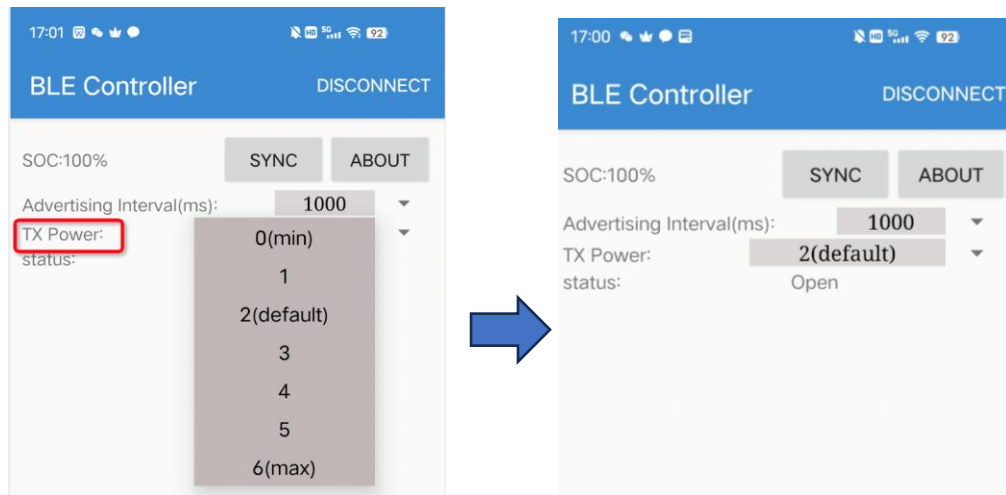

## 6. Working Mode:

### 1) Bluetooth Wireless Connection ONLY

Model: BD01

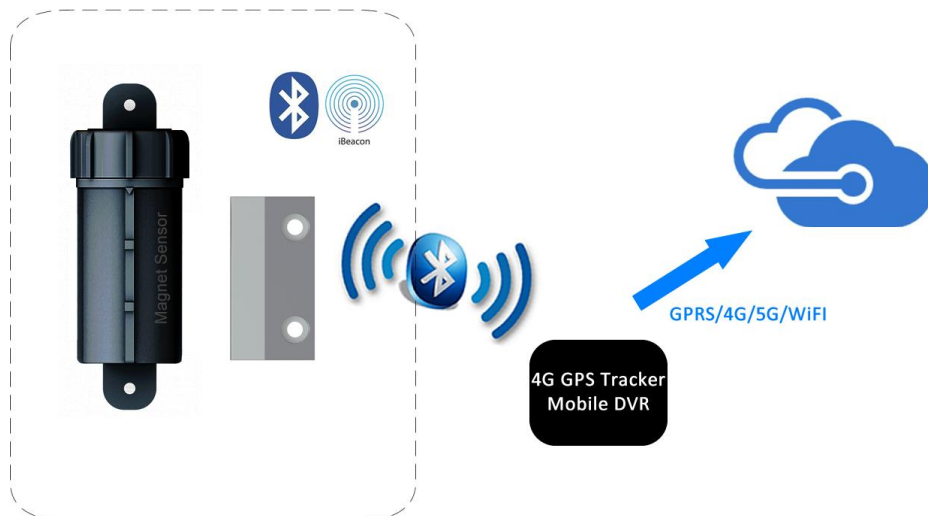

### 2) Bluetooth IoX Gateway with RS232/RS485/IO output

Model: BDC01

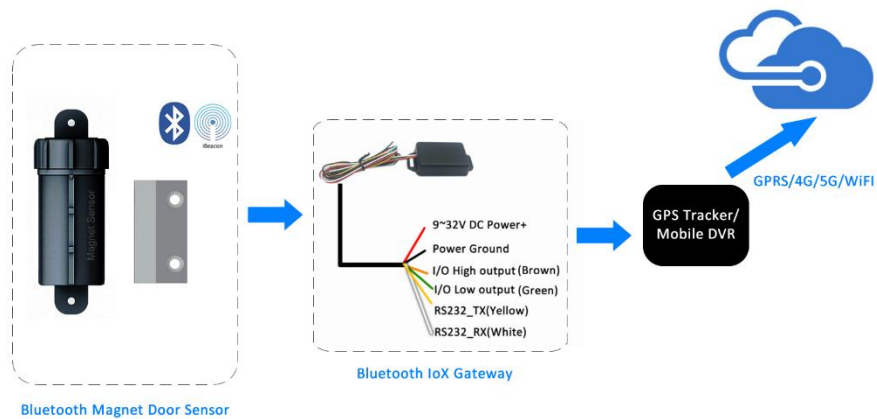

## 7. Teletonika BLE device Setting Guide

Load from device

Save to device

Update firmware

Reset configuration

Load from file

Save to file

Read records

Reboot device

IMEI 359633107969045  
 FW 03.25.15 Rev01  
 Configuration 6.1.14.0

Status

Security

System

GPRS

Data Acquisition

SMS \ Call Settings

GSM Operators

Features

Accelerometer Features

Auto Geofence

Manual Geofence

Trip \ Odometer

Bluetooth

Bluetooth 4.0

Beacon List

1-Wire

I/O

OB2 II

CAN Adapter

RS232 \ RS485

Common settings

Non Stop Scan

Disable

Enable

Sensors and Beacons Update frequency

30

BLE Scan duration

5

Scan retries until error

30

BT Power Level

1

2

3

4

5

6

7

BLE broadcasting service ID

BLE connection control

Prohibit

Allow

BLE connectionless functionalities

Connection #1

Mode

Working mode

Disabled

TZ-BT04/05/05B sensor

Advanced

Settings

MAC

SC5310508345

1st Sensor

Type	Data Offset	Data Size	Action	IO	Match	Endianess	Multiplier	Offset
FF	6	1	Save	Fuel		Big Endian	1	0
	0	0	Match	None		Big Endian	1	0
	0	0	Match	None		Little Endian	1	0